

FLEXIBILITY FOR INNOVATORS ONLY

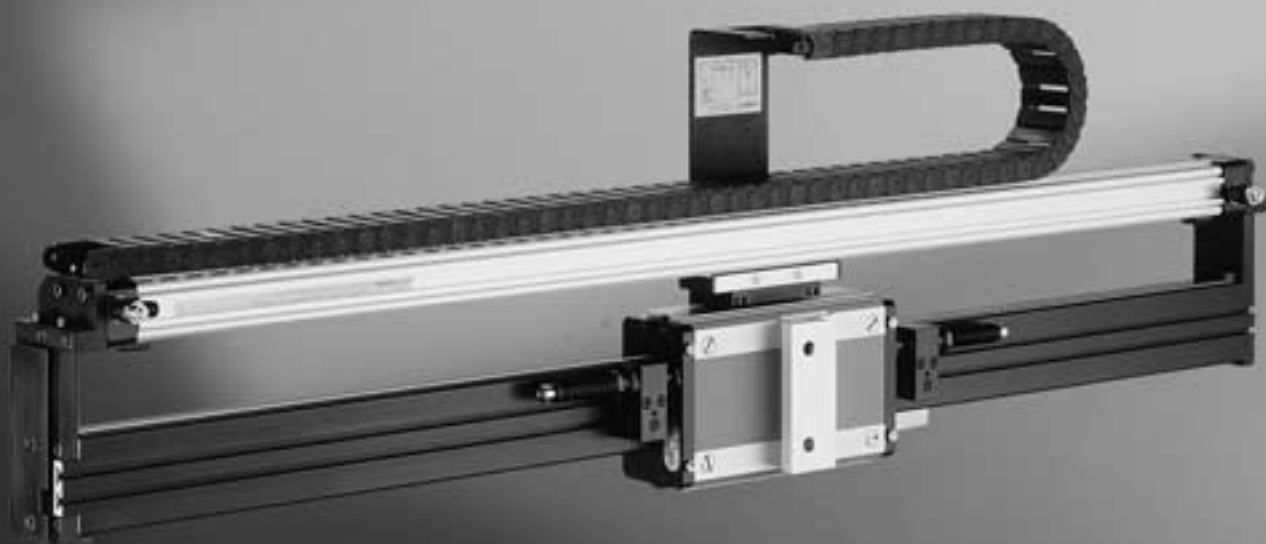

EFFECTIVE
UNCOMPLICATED
COMPLETE



LONGSTROKE- SLIDES

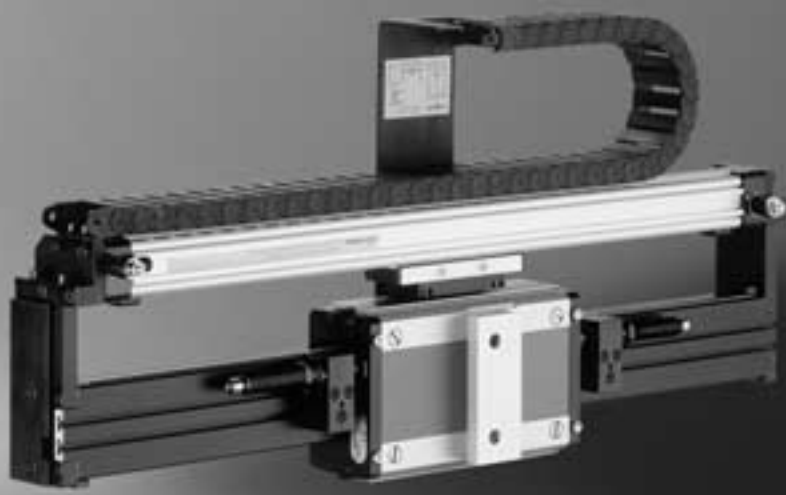

LONGSTROKE-SLIDES PS CONTENTS

PRODUCT DESCRIPTION 212-213



APPLICATIONS 214-215



LONGSTROKE-SLIDES 216

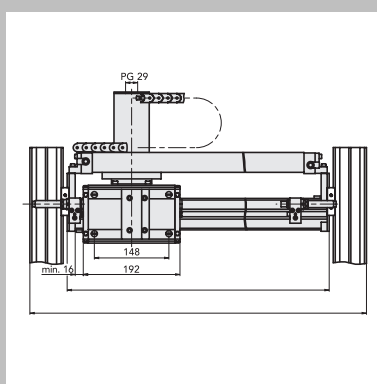

**TECHNICAL DATA/
DIMENSIONS****217-219**

LONGSTROKE-SLIDES PS PRODUCT DESCRIPTION

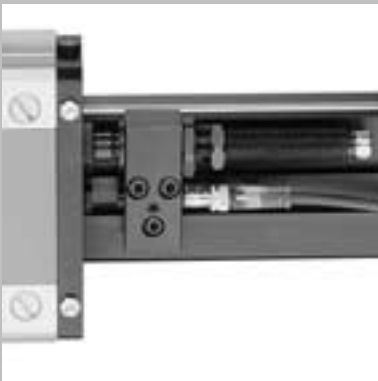

The **Longstroke-Slide PS** serves as the **basic element** for the lifting range 400 to 600 mm. It was designed as a **simple portal loader** with movement to two freely chosen positions.

The two enclosed rectangular profiles provide the PS with **excellent rigidity**.

The **rollers** in the slide and the hardened **precision round bars** embedded in the portal profile form the **guide system which has been set so as to be free of play**.

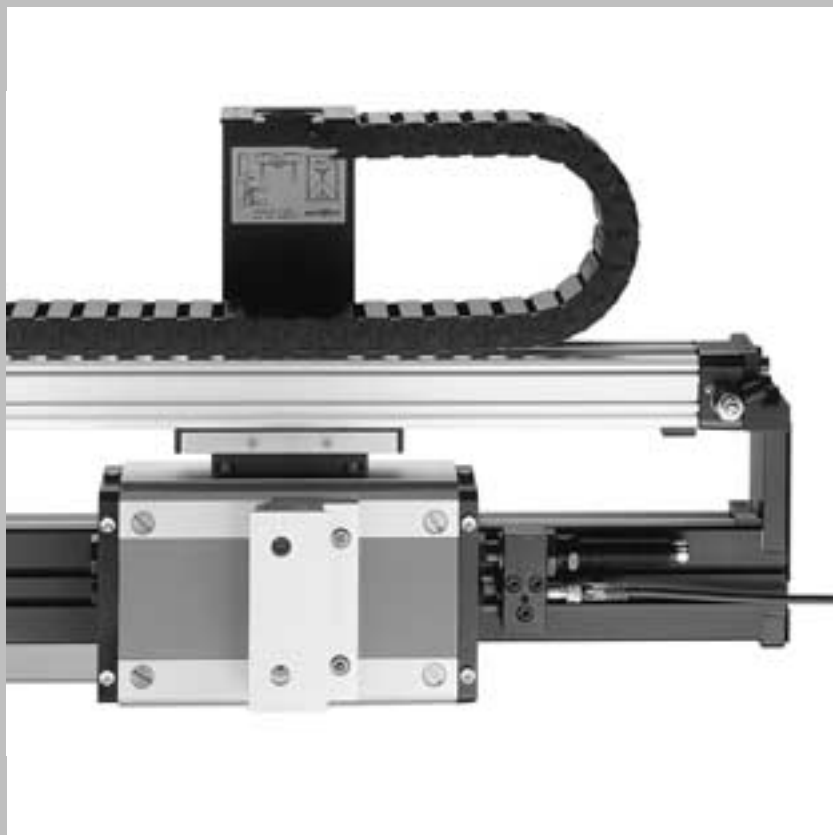

The system is driven by a cylinder with no piston rod.

The **shock absorbers** feature precision adjustment.

The end positions can be queried with **inductive proximity switches**.

The electric cables and pneumatic hoses can be run to the attached elements in an orderly manner; an **energy supply chain** is employed. The output end of this supply chain can be arranged to suit the user's requirements.

The unit's dovetail design makes for easy installation/adjustment. (See Quick-Set® page 338.)

APPLICATIONS



Placement device in portal design; horizontal stroke provided by a Portal Slide PS; built-on Linear Unit LEP combined with a Precision Parallel Gripper GPP.



Transposition unit in portal design; two Compact Slides KSD, with Dual-Acting Parallel Grippers GPD, are built onto a Portal Slide PS with a TP-66-40 and an SLL-55-40.

LONGSTRIKE-SLIDES PS

One design size available in two standard lengths.

SCOPE OF DELIVERY

The portal slides are supplied including two shock absorbers, two exhaust chokes, two retainers for proximity switches, two adjustable end stops and a user manual.

SUITABLE ACCESSORIES

Accessories
Quick-Set®

from page 302
from page 338

DEFINITION OF LOAD

S: Center of gravity of ancillary unit
 Lz: max. 100 mm

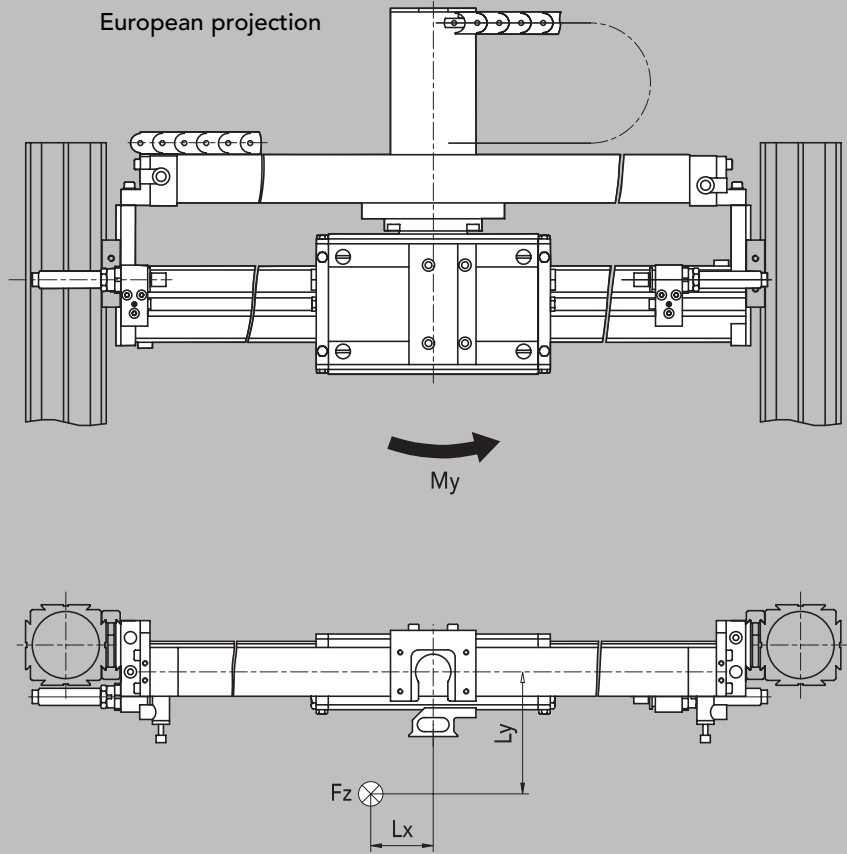
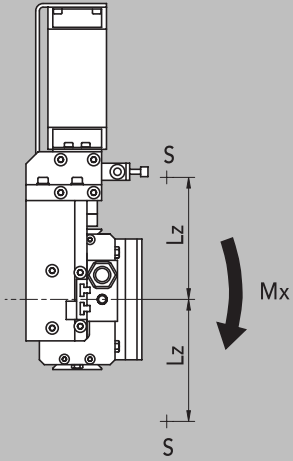

DEFORMATION

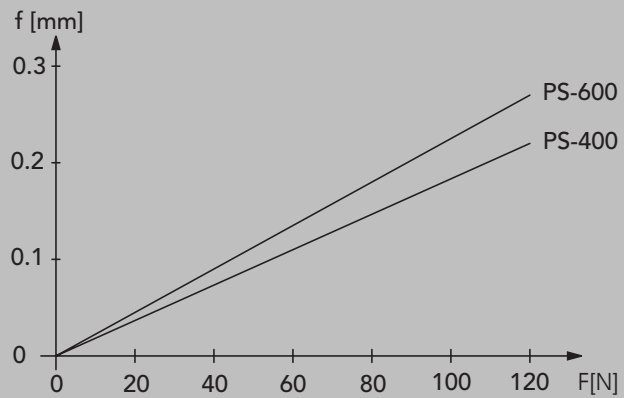
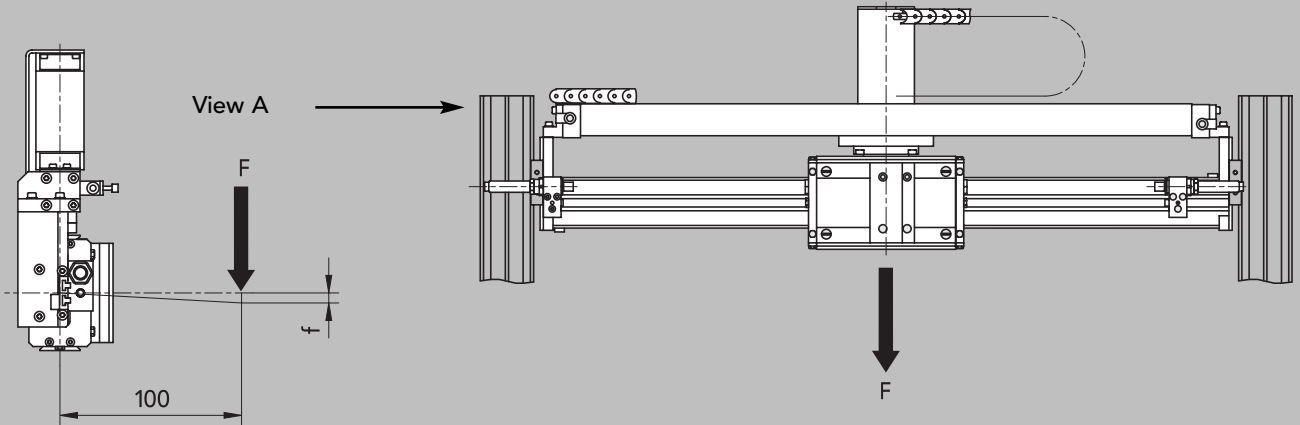

LONGSTROKE-SLIDES PS

		400	600
Stroke max.	[mm]	400	600
Force to move in/out at 5 bar	[N]	200	200
Payload unthrottled	[kg]	8	8
Payload throttled (2 turns)	[kg]	12	12
$M_x (F_z \cdot L_y)$ perm.	[Nm]	12	12
$M_y (F_z \cdot L_x)$ perm.	[Nm]	5	5
Weight	[kg]	6.5	7.5
Operating pressure	[bar]	3–6	
Operating medium		air, oiled or unoled, filtered to 5 μm , dew point < 6°C	
End stop absorption		hydraulic shock-absorbers	
Repeatability 1)	[mm]	< 0.01	
Check of end position 2)		inductive proximity switches	
Pneumatic connection		hose- \varnothing 6 mm	
Speed regulation		adjustable exhaust throttles G1/8"	
Ambient: Temperature	[°C]	10–50	
Rel. humidity		< 95% (without condensation)	
Air purity		normal workshop atmosphere	
Guaranty period		2 years from the date of delivery	
Maintenance		oiling the rods	
Material		aluminum, steel, plastic	

- 1) Scatter of end positions of 100 successive strokes under constant conditions
 2) See accessories page 302

TRAVEL TIME DIAGRAM

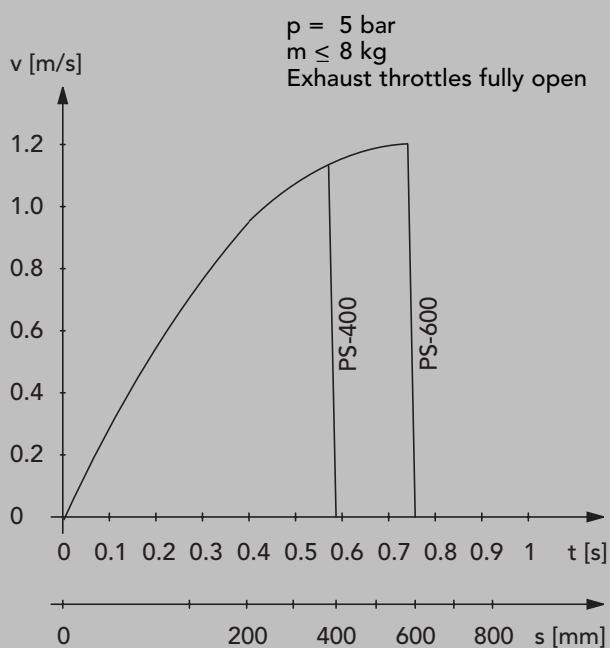

European projection

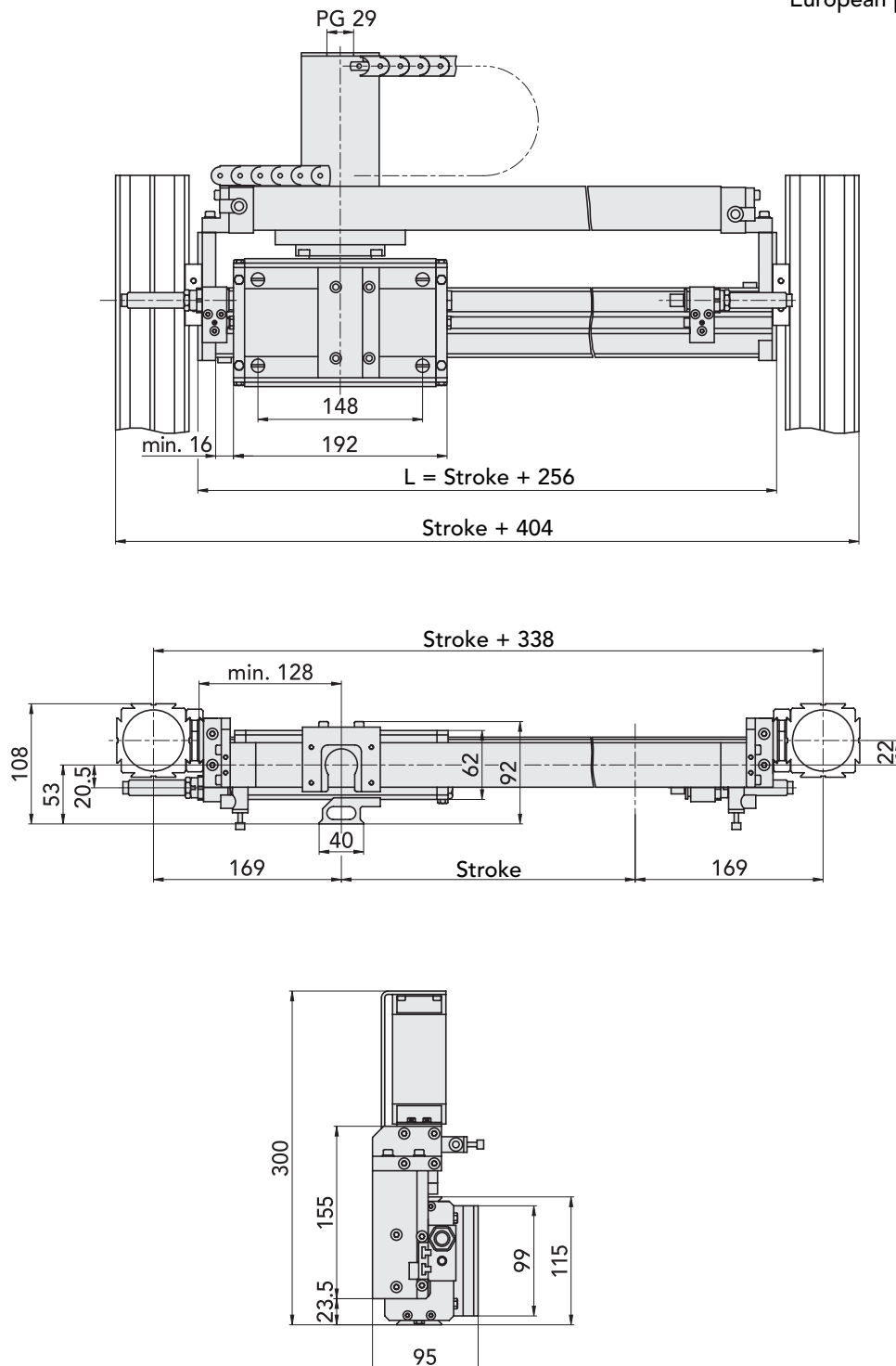

Ref. No.
 PS-400-1
 PS-600-1

46273
46141